

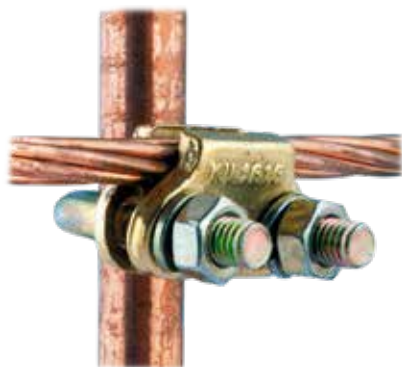

Product data sheet



CLAMP KU

Description

One-wire clamp for cable/pipe connection, consisting of two hot-stamped bodies, tightened by means of a clamping ring.

Specifications

Material	Brass body
Hardware	stainless steel
Tolerance	//
Length	//
Package	5 unit
Customs code	74122000

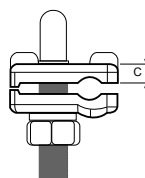
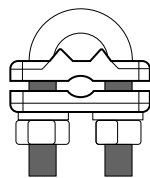
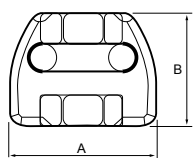

Code	REF.	Rod (mm ²)	ØWire(mm)	A/B/C	T	Kg/U
06378	KU1616	15	16-35	40/24/5	M8	0,10
06766	KU1616*	16	16-35	40/24/5	M8	0,10
06379	KU1625*	20	25-70	50/38/7	M10	0,25
06534	KU2025*	20	25-70	50/38/7	M10	0,25
06766	KU1663*	20	70-95	52/37/7	M10	0,25
06567	KU2012*	20	95-185	10-18	M10	0,42

*Stainless steel hardware.